

货架目录

RACKING CATALOGUE



仓储设备制造及功能解决方案专家

广州威裕物流应用技术有限公司

BPS GLOBAL (GUANGZHOU) OFFICE
Expert in Warehouse Equipment and Manufacturing Solutions

目錄

TABLE OF CONTENT

01	Company Profile 公司简介
02	Factory Scene 工厂实景
04	Light Duty Shelving 轻型货架
06	Medium Duty Racking 中型层板货架
07	Medium Cross Beam Shelves 中型横梁式层板架
08	Selective Pallet Racking 重型横梁式货架
10	Drive-in Racking 驶入式货架
11	Rack-Supported Mezzanine 阁楼式中层货架
12	Mezzaine Floor 钢平台
13	Gravity Roller Rack / Gravity Roller Type Shelves 重力滚轮式货架 / 重力滚筒式货架
14	Push Back Racking 推入式货架
15	Mobile File Shelving 移动式文件柜
16	Stacking Rack Stillage / Collapsible Wire Mesh Container 巧固架 / 可折叠置物笼
17	Steel Pallet / Wire Mesh Partition 钢托盘 / 金属隔离网



仓储设备制造及功能 解决方案专家

EXPERT IN WAREHOUSE EQUIPMENT
AND MANUFACTURING SOLUTIONS

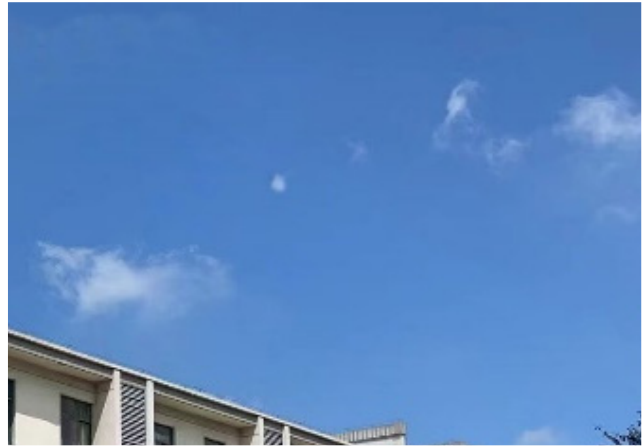

COMPANY PROFILE 公司简介

广州威裕物流应用技术有限公司按不同工商业需要及自身业务发展，活用最新科技，从而使客户在身处的行业领域中，成为耀眼的明灯。我们的团队具备专业能力，可提供从设计、生产到安装一站式解决方案，包括各种轻型货架、重型货架、滚筒式货架及移动式货架等。

BPS Global (Guangzhou) Office utilizes the latest technology according to different commercial and industrial needs and its own business development so that customers can stand out from the crowd within the industry. Our team is capable of providing one-stop solutions from design, production to installation, include light and heavy duty shelving, roller rack, mobile rack and more.

FACTORY

FACTORY SCENE 工厂实景



货架设备生产基地位于南京市江宁工业园区，工厂技术室自行设计、开发多条立柱、横梁等轧制线；进口多条自动冲孔专用线；依托宝钢卷板资源优势，从原料冷板卷板的纵剪、冲孔、定尺到一次成型采用流水线作业；公司引进欧洲自动静电粉末喷塑线主机，无污染式抛丸喷砂前处理，形成一套完整的生产体系。

产品严格按 ISO9001: 2000 质量认证体系的要求运行，始终追求先进的国际管理模式，不断吸收国际国内物流行业的先进技术，结合国内企业实际情况，不断进行钢结构技术及力学理论的研究，在引进、消化国外先进技术的基础上自主研发开发，不断创新进取，使威裕物流始终处于国内物流行业领先水平。

工厂的计算机辅助设计及计算机辅助制造（CAD、CAPP、CAM）系统，可以按照用户的要求，设计出合适的物流处理方案。用户在物流处理方案有任何要求，威裕将以其丰富的经验，随时为您找出适当的、合理的解决方案。

威裕公司为实现客户的物流战略，不断吸收新思想、新理念、新技术力图创建品牌，以综合物流系统一体化为目标。



The racking and equipment production factories are located in Nanjing Jiangning Industrial Park. The factory's technical department independently designs and develops multiple columns, beams and other binding lines, and imports multiple automatic punching dedicated lines. Relying on the resource advantages of Baoshan Iron & Steel rolled sheet, from the longitudinal front, punching, fixed-length to one-time forming of the raw material cold-rolled sheet, the streamlined production is used. The company has introduced the main machine of the European automatic electrostatic powder spraying line, and the pollution-free sandblasting pre-treatment, forming a complete production system.

The products are strictly operated with the requirements of the TSO9001: 2000 quality certification, and always pursue advanced international management models. BPS Logistics Technology continuously acquires advanced technologies in both international and domestic logistics industries and combines them with domestic enterprises and continuously conducts research

on steel structure technology and mechanics theory, as well as independent research and development on the basis of introducing and absorbing advanced foreign technologies, and constantly innovating ahead so that BPS Logistics Technology is always at the forefront of the logistics industry.

The factory's computer-aided design and computer-aided manufacturing (CAD, CAPP, CAM) system can design appropriate logistics handling solutions according to user requirements. If users have any requirements for logistics handling solutions, BPS Global Holdings (Guangzhou) Office will use its rich experience to find appropriate and reasonable solutions for the client at any time.

BPS Global Holdings (Guangzhou) Office strives to create a brand by continuously absorbing new ideas, concepts and technologies to realize customers' logistics strategy, with the goal of integrated logistics system integration.

LIGHT DUTY SHELVING

轻型货架

轻型货架适合存放体积细小及重量轻的货物，广泛应用于电气、轻工、超市、文化及教育等行业，其特点包括：

Light Duty Shelving is ideal for storing light and small items which is widely used in the electrical, light industry, supermarket, cultural and education industries. Its characteristics include:



- 通用角钢立柱
- 嵌入式钢层板
- 简单快速的组装和拆卸
- 每层高度可自由调节，间距为 50mm
- 手动装卸
- 每层负载能力小于150kg

- Universal angle steel upright
- Cut-in composite with steel panel
- Fast and easy assembly/ disassembly
- Height of each layer can be adjusted freely by pitch of 50mm
- Manual assembly/disassembly
- Loading capacity of up to 150kg per shelf

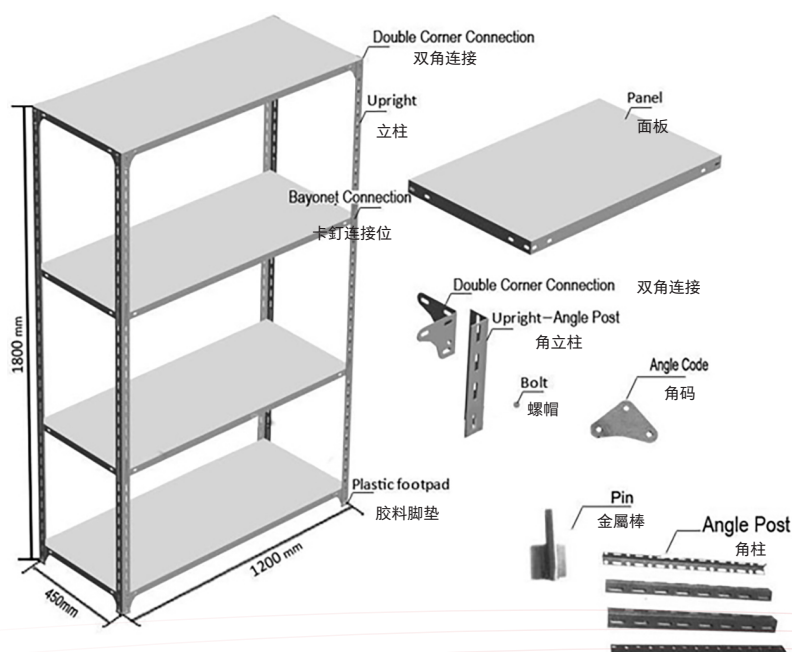

Double Corner Connection - 双角连接

Upright - 立柱

Panel - 面板

Bayonet Connection - 卡钉连接位

Upright Angle Post - 角立柱

Bolt - 螺帽

Angle Code - 角码

Plastic Foot Pad - 胶料脚垫

Pin - 金属棒



钢板

具高质量钢条, 承载能力更强, 货架更坚固, 安全性更高

Steel Panel

With high-quality ribs, which has stronger bearing capacity, stronger shelves and higher safety

脚垫

人性化且贴心设计, 能保护地板不受损坏也可防止货架在搬运和推动过程中磨损

Foot Pad

Humanized and intimate design, to protect the floor from damage and also prevents the rack from being worn during handling and pushing

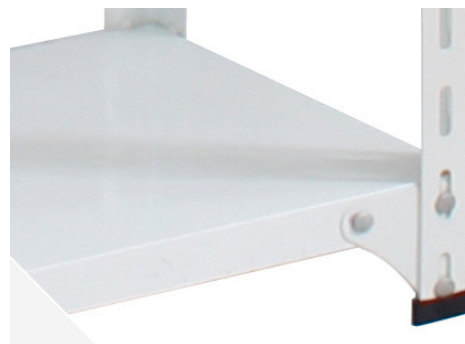

自由调节

易于拆卸和组装, 可以根据需求自由调整层板

Freely Adjustable

Easy disassembly and assembly, can freely adjust the laminate according to demand

轻型货架的常用模型 Usual Model of Ligh Duty Racking

模型 Model	尺寸 (长 x 宽) (mm) Size (Length x Width) (mm)	每层承载力 (kg) Capacity of Each Layer (kg)
NL101	900×300	100
NL102	900×450	150
NL103	900×600	200
NL104	1200×450	150
NL105	1200×600	150
NL106	1500×450	100
NL107	1500×600	100
NL108	1800×450	100
NL109	1800×600	100
立柱规格 (mm) Size of Upright	角钢 Angel Steel 38×38×1.8, 57×38×1.8	节距 Pitch 50
		高度 Height 1.5-3m

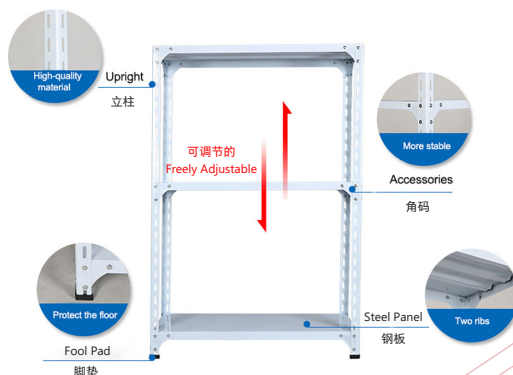

MEDIUM DUTY RACKING

中型层板货架

中型货架又称大跨度货架，适用于大体积、大件货物，也可储存高密度的小货物。

Medium duty racking also called long span shelving, which is suitable for large volume, bulky goods and containers, also storage high density of small goods.



- 无螺栓锁定结构，简单快捷的组装和拆卸，无需使用任何螺栓和螺母或其他工具
- 高强度钢板，带焊接支撑杆
- 每层高度可通过50mm的间距自由调节
- 每层承载能力可达400公斤
- Boltless lock-in structure, simple and quick assembled and disassembled without using any bolts & nuts or other tools
- High strength close-steel panel with welded support bars
- Height of each layer can be freely adjusted by pitch of 50mm
- Loading capacity up to 400kg per level



深度 (毫米) Depth(mm)	每層容量 (千克層) Capacity Per Layer (kg Layer)	長度 (毫米) Length (mm)		
		1200	1500	1700
470		300	250	250
600		350	300	250
720		350	300	250
920		450	400	400
1180		450	400	400
立柱尺寸 (毫米) Column Size (mm)		55*55*1.5 節距 = 50 H=1.5,1.8,2.0,2.4,3.0(m)		



MEDIUM CROSS BEAM SHELVES

中型横梁式层板架

中型货架可用于手动装载应用，其装载能力是中型货架 A 的两倍，适合存放金属部件，广泛使用在制造业使用。

Medium duty racking is also used for hand loading application, which loading capacity is twice of medium duty racking A. Compared with the NMA, it is more suitable for storing metal components and widely used in the manufacture industry.

- 锁紧式阶梯梁，钢板或木板
- 每层高度可通过间距50mm轻松调节
- 每层负载可达800kg
- 根据客户要求定制制作

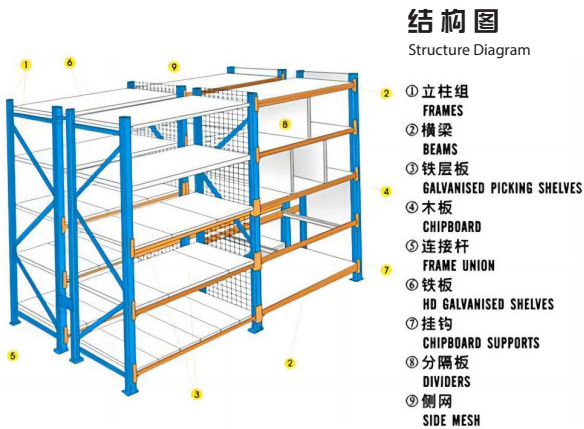

- Lock-in step beam, steel or wooden panels
- Height of each layer easily adjusted by pitch 50mm
- Capacity of each level is up to 800kg
- Customized making to clients' requirements

長度 (毫米) Length (mm)	1200 1500 1800 2000 2200 2500
深度 (毫米) Depth (mm)	400 450 500 600 800
高度 (毫米) Height (mm)	1200-3000
每杆载重量 (公斤) Load Capacity Per Pole (kg)	200-800
立柱尺寸 (mm) Column Size (mm)	55x47x1.5/2.0 或 60x50x1.5/2.0 間距 =50 高度 =1.3 米

阶梯梁
Step Beam:

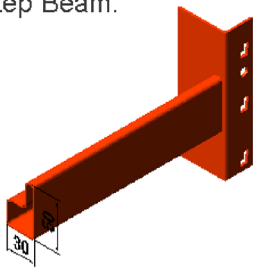

P50*30*1.5mm

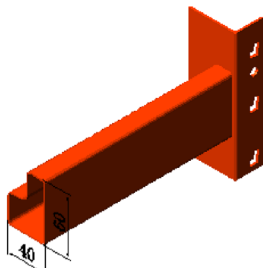

P60*40*1.5mm

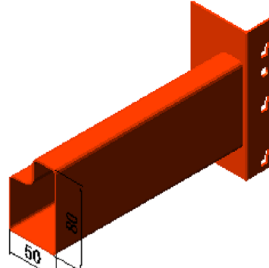

P80*50*1.5mm

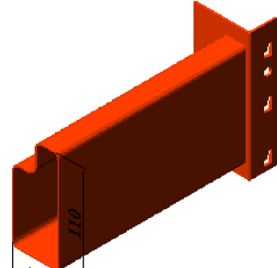

P110*50*1.5mm

SELECTIVE PALLET RACKING

重型横梁式货架

重型横梁式货架是一种经济高效的存储系统，可直接存取所有托盘。它提供高容量存储，易于安装和调整，设备和资金成本低。

我们确保提供最高效的托盘货架解决方案，无论是按照您的计划工作，还是开发符合您需求的经济高效的布局。您可以放心使用设计最佳、效率最高、最安全的货架。

Selective Pallet Racking is a cost effective storage system providing direct access to all pallets. It provides high capacity storage, is easily installed and adjusted, and has low equipment and capital costs.

We ensure the most productive pallet racking solution is provided whether working from your plans or developing a cost-effective layout that is just right for your needs. You are assured of the best designed, most efficient and safest racking.

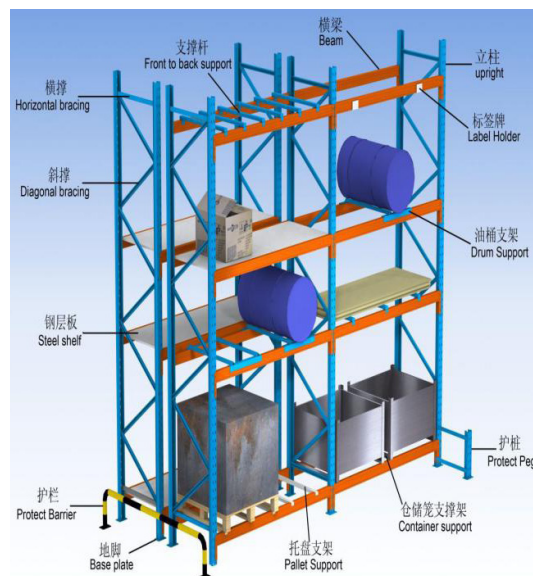

特征:

- 托盘可以单独定位、存取和移动
- 快速处理几乎所有类型的托盘货物
- 充分利用垂直空间
- 这种架子每个架子的承载能力可以达到4,500kg
- 强度和刚度可防止重压损坏货物
- 托盘的底层可以存放在地板上，从而降低了结构成本
- 耐用的粉末涂层表面，外观清洁，防火
- 水平高度可调节75mm或76.2mm



Features:

- Pallets can be located, accessed and moved individually
- Rapid handling almost all types of palletized goods
- Fully utilizes vertical space
- The bearing capacity per shelf of such rack may reach 4, 500kg
- Strength and rigidity prevents compression damage to goods
- Bottom level of pallets can be stored on the floor, lowering structure costs
- Durable powder coated finish, clean appearance, fire proof
- Height of level can be adjusted by 75mm or 76.2mm



直立部分

Upright Section

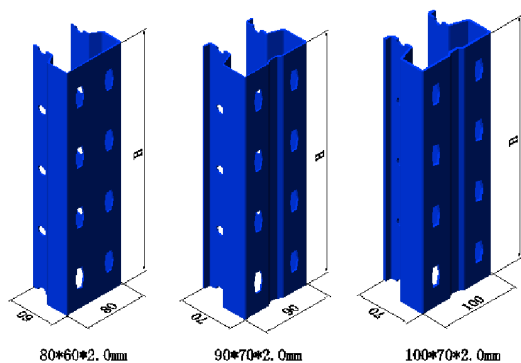

层板架部分

Beam Section

Box Beam:

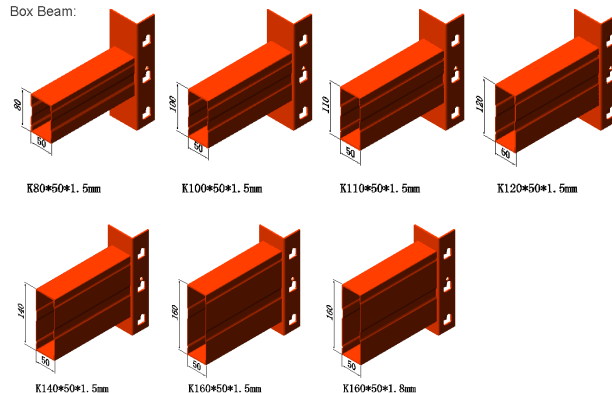

连接方式

Connection Method



双直立

Double Upright



连接式双立柱

Connection Way Double Upright



阶梯梁
Step Beam:

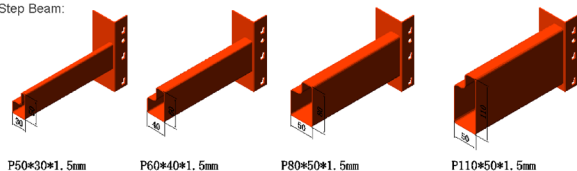

VNA(非常狭窄巷道)货架双深托盘货架

VNA (Very Narrow Aisle) Racking Double Deep Pallet Racking

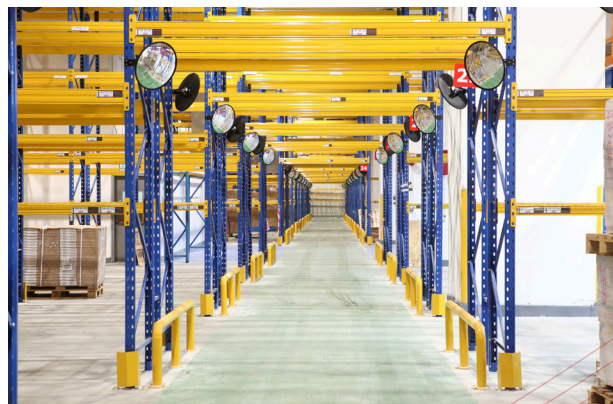

DRIVE-IN RACKING

驶入式货架

驶入式货架提供高密度且节省空间的产品。驶入式或双通道系统由连续的货架通道组成，只有一个储存和取货通道。装载和卸载是通过平衡或前移式叉车进行，这些叉车沿着每条通道驶入货架。

Drive-in racking provides a high-density and very space-efficient. Drive In or Double Access Systems consists of continuous lanes of racking with only a single load and retrieval aisle. Loading and unloading is undertaken by means of counter balance or reach trucks that drive down each lane into the racks.

特征：

- 仓库的利用率非常高
- 可以先进先出或先进后出
- 钢结构结构，经久耐用
- 托盘位置配置为2至5深和2至5高，充分利用屋顶下空间
- 表面处理：粉末涂料
- 适合存放大批量货物
- 广泛应用于奶制品、饮料行业，同样适用于冷库

Features:

- Very high utility ratio of the warehouse
- Can first in - first out or first in - last out
- Structural steel construction for durability
- Pallet positions configure from 2 to 5 deep and 2 to 5 high deal for roofing
- Finish: Powder coating
- Suitable for storing few type of goods with large quantity
- Widely used in milk, drink industry, and also be welcomed by cold storage

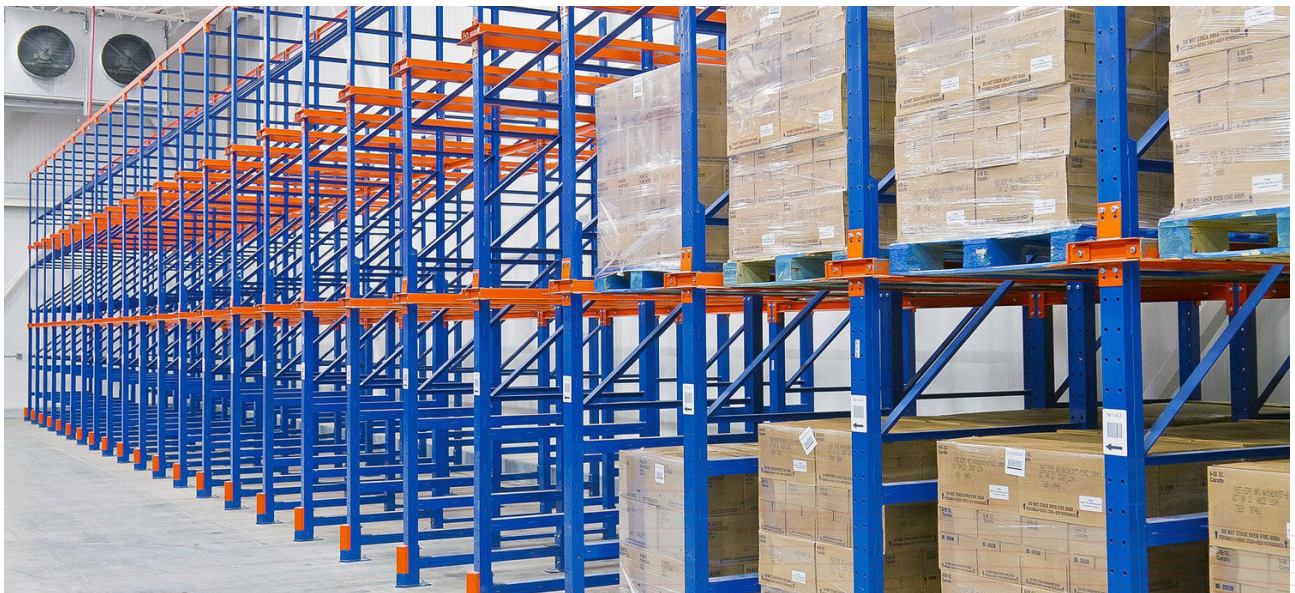

RACK-SUPPORTED MEZZANINE

阁楼式中型货架

阁楼式中型货架是使用标准货架组件创建额外楼层的最经济的方式，该组件利用仓库的立方面积，最大限度地扩大存储空间。

您可在现有货架区域上建造阁楼式货架，提高工作流程效率和空间利用率，阁楼式中型货架有效消除等待时间和昂贵的搬迁成本。

重型 (中型) 货架构成阁楼的主要部分，钢板走道连接所有货架，构成阁楼的主体结构。专用连接件将走道和货架支架固定牢固。该走道具有承载能力好、精度高、走道表面平整、固定方便等优点。阁楼设有照明系统，便于进出和管理货物。



特征：

- 采用复合货架结构，专利轻钢地板结构
- 地板承载能力大，成本低，施工快捷
- 可根据实际情况设计成一层或多层
- 确保最充分的空间利用率
- 提供对所有托盘的直接存取
- 表面：粉末涂层或镀锌，颜色可选
- 从1楼到2楼的一般运输方式：手动，升降台，起重机，输送带，叉车
- 可根据客户要求设计

Rack-supported mezzanines are the most economical way to create an additional floor level using standard pallet rack components, which utilize the cubic area of warehouses and maximizes your storage space.

Rack-supported mezzanines can be built over existing equipment and work areas. By improving workflow efficiency and space utilization, rack-supported mezzanines can eliminate downtime and expensive relocation costs.

Heavy (medium) duty racking forms the main parts of the Mezzanine, and cold rolling walkways connect all shelving to build a whole structure of Mezzanine. Special locks are used to fix walkway and catwalk tightly. The walkway has such advantages as good loading capacity, high precision, quite smooth walkway surface, and it's easy to be fixed. The mezzanine is equipped with lighting system, easy for accessing and management of goods.

Features:

- With composite racking structure, patented light-steel floor panel structure
- Floor panel with large load capacity, low cost, quick construction
- Can be designed into one layer or multi layers according to actual situation
- Ensures the fullest space utilization
- Provides direct access to all pallets
- Surface: Powder coated or galvanized and color optional
- General ways of transportation from 1st floor to 2nd floor: Manual, Elevating table, hoisting machine, conveying belt, forklift truck
- Can be designed according to clients' requirements

阁楼中货架的荷载通常小于每平方米 500kg，阁楼的高度在 2200 到 2700mm 之间。阁楼顶部的货架高度约为 2000mm，充分考虑了货物的装卸。

配备了楼梯、液压升降台和升降机，并与叉车相结合，用于将货物从地面移动到地板。阁楼可根据客户要求自由设计为两层或三层，充分利用存储空间。这种阁楼广泛应用于汽车、电子、轻工、机械等领域。

Loading of the shelving in mezzanine is normally less than 500kg per square meter, level height of mezzanine is between 2200 to 2700mm. Height of shelving on top of mezzanine is around 2000mm, taking loading and unloading of goods into good consideration.

Staircase, hydraulic lift table and lift are equipped, combined with forklifts, for moving goods from ground to floor panel. Mezzanine is freely to design to be two-layer or three-layer based on the requirements from customers, taking full use of the storage space. This kind of mezzanine is widely used in the fields of automobiles, electronics, light industry and mechanics, etc.

MEZZAINE FLOOR

钢平台

这种钢制平台可以在一个仓库地面上自由安装或拆卸，立柱之间的距离小于 6000mm。第一层的高度约为 3000mm，第二层和第三层的高度为 2500mm。地板的承载能力可设计为不超过 1000kg/ 平方米。

This kind of garret can be installed or dismantled freely from one warehouse ground and distance between columns is less than 6000mm. Height of first level is around 3000mm, and H 2500mm for second and third floor level. Loading capacity of floor can be designed to be no more than 1000kg/ square meter.



特征：

- 最大化工厂或仓库的立体空间
- 节省新建筑成本
- 匹配新的生产和装配区域
- 卓越的生产力、存储和利润
- 节省建筑维护成本
- 节省成本
- 降低空间成本
- 最大化您的库存控制
- 加快产品分销
- 节省往返多个地点的搬运时间
- 增加区域安全性

Features:

- Maximize cubic space in your plant or warehouse
- Save on new construction costs
- Create new production and assembly areas
- Great productivity, savings, and profit
- Save building maintenance costs
- Save on property taxes and land acquisition costs
- Eliminate leased space costs
- Maximize your inventory control
- Speed up product distribution
- Save travel time to and from multiple locations
- Secure an area to eliminate theft problems



GRAVITY ROLLER RACK

重力滚轮式货架

结构特点：

货架是由中型货架发展而来的。每层一对梁之间设有铝或钢制辊道，形成 3 度的坡度，在重力的驱动下，实现货物的“先进先出”。

进出方便，适用于装配线两侧、配送中心等场所，可与输送机等存储解决方案集成，打造功能拣选模块，提高仓库产品拣选效率。

货架的高度通常低于 2.5M，每层的装载能力最多为 1000kg。



Structure Features:

The racking is developed from the medium duty racking. Aluminum or steel roller rail are equipped between a pair of beams per layer to form a slope of 3 degree, and under the driven of gravity, "first in first out" of goods are realized.

It is convenient to access and suitable for such places as the two sides of the assembly lines, distribution centers, etc, and can be integrated with conveyors and other storage solutions to create functional pick modules and warehouse product picking efficiency.

The height of the racking is normally lower than 2.5M and the loading capacity of each layer is 1000kg at the most.

GRAVITY ROLLER TYPE SHELVES

重力滚筒式货架

结构特点：

关于重力托盘货架，托盘被放置在通过重力驱动向拣选面倾斜的滚轮上，实现“先进先出”。

托盘从一侧进料，并从另一侧取回，消除了接收区域的双重处理。吞吐量速度与自动库存周转相结合是该系统的主要优势。

它适用于充分利用存储空间存储大量和相同类型的货物。它特别适用于有效期短的货物。如果坡度较长，应配备制动器；分离器和缓冲器是必要的，以防止货物周转。每个托盘的装载能力小于 1000kg。它可以用作运输区域，生产，货物接收和发送的缓冲存储。

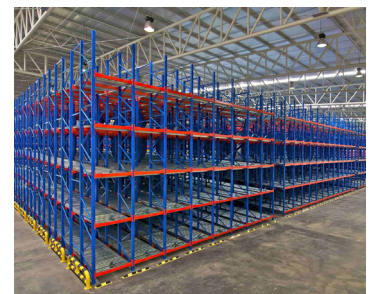

Structure Features:

Regarding the gravity pallet racking, pallets are placed on rollers that slope toward the pick face by gravity driven, "first in and first out" is achieved.

Pallets are fed in from one side, and retrieved from the opposite side eliminating double handling from the receiving area. Speed of throughput combined with automatic stock rotation is the major advantage of this system.

It is suitable for storing goods with large quantity and same type taking full advantage of storage space. It is especially suit for the goods with short expiration date. Brakes should be equipped if the slope is long; separators and buffer is necessary to prevent the goods turn over. The loading capacity is less than 1000kg per pallet. It can be used as buffer storage in shipping areas, production, goods reception and dispatch.

PUSH BACK RACKING

推入式货架

后推式货架统有结构框架或滚压框架。后推式货架系统的工作原理是将托盘负载放在一系列筑料车上，这些套料车在刚性结构钢轨上通过重力向前馈送。当托盘从前面装载时，它会将后面的托盘推回一个位置。卸货时，前托盘被移除，后托盘自动向前移动到前拣选位置。

Push back rack systems are available in structural or roll-formed frames. Push back rack systems work by placing pallet loads on a series of nesting carts fed forward by gravity on rigid structural steel rails. As a pallet is loaded from the front, it pushes the pallet behind it back one position. When unloading, the front pallet is removed and the rear pallets automatically come forward to the front picking position.



特征：

- 通过将高密度存储与高速提取相结合，提供高效的空間利用
- 根据FILO（先进后出）原则进行操作。
- 储存2-5个托盘深的产品
- 单托盘重量，货物通常小于1500kg

Features:

- Provides highly effective use of space by combining high density storage with high speed access
- Operates on the FILO (First In, Last Out) principle.
- Store product from 2-5 pallets deep
- Weight of single pallet with goods normally less than 1500kg

由于仅从单个通道进行正面装载，后推式提供比驶入式机架更通用的存储，因为每个通道独立流动，垂直存储与下面的通道分开运行。可以存储和检索各种 SKU 的多个拣选面，而不会以单通道或双通道格式干扰上方或下方的其他产品。

With front-only loading from a single aisle, push back offers more versatile storage than Drive-In rack because each lane flows independently and vertical storage operates separately from lanes below. Multiple pick facings for a variety of SKUs can be stored and retrieved without disturbing other product above or below in a single-lane or double-lane format.

MOBILE FILE SHELVING

移动式文件柜

移动文件柜是一种经济高效的增加存储容量和利用宝贵占地面积的方法，与传统的静态搁板相比，它可以使存储容量翻倍。

它广泛用于办公室的文件存储，设计为易于重新定位，无需固定地板。它沿着地板轨道移动，允许移动过道，以便可以访问所需的货架，因此只需要一个过道。

主要应用：图书馆和档案馆，零售库房，医疗记录，办公室档案和博物馆。



Mobile File Shelving is a cost effective way of increasing storage capacity and utilizing valuable floor space, which can double storage capacity compared to conventional static shelving.

It is widely used in offices for file storage and are designed to be easily re-located with no floor fixing.

It moves along floor tracks allowing the aisle to be moved so that the required shelves can be accessed, so only one aisle is needed.

Main application: Libraries and Archives, Retail Stockrooms, Medical Records, Office filing and Museums.

自动化仓库 (AS/RS)

自动存储和检索系统（AS/RS）提供托盘、箱子、散装产品或周转箱的自动缓冲、暂存和运输。

技术最大限度地减少了劳动力，并最大限度地利用了现有的垂直空间。

为了减少人员配备、提高性能并保持准确性，任务关键型设施在各种应用中使用 AS/RS，包括：

- 大量货物进出存储;
- 由于空间限制，存储密度很重要;
- 在此过程中不存在额外费用;
- 精度至关重要，因为可能运作期间出现损坏，付出高昂费用。



Automated Storage and Retrieval Systems (AS/RS) provide automated buffering, staging and transportation of pallets, cases, bulk product or totes.

AS/RS technology minimizes labor and maximizes the utilization of existing vertical space. AS/RS

To reduce staffing, improve performance and maintain accuracy, mission critical facilities use AS/RS in a broad variety of applications including:

- Very high volume of loads being moved into and out of storage;
- Storage density is important because of space constraints;
- No value adding content is present in this process;
- Accuracy is critical because of potential expensive damages to the load Station equipment.

STACKING RACK STILLAGE

巧固架

堆叠架是不断变化的存储需求的理想选择。焊接钢结构，重量轻，可以根据要求的变化轻松移动或更改，并安全地堆叠到四个单元的高度。价格低廉且易于制作，在安装或移动过程中无需工具。

堆垛架用于存储那些不能很好地存放在标准架子上的小件重物，非常适合存放原料棒、管材、型材、成型件、特种木材和零件。



Stacking Rack Stillage are ideal for changing storage needs. Welded steel construction yet light weight, they can be easily shifted or changed as requirements change and stack safely up to four units high. Additions are inexpensive and easy to make, no tools required during initial set-up or moving.

Stacking Racks are Used for storage of those small heavy items that do not store well on standard shelving, Ideal for storing bar stock, pipe, tubing, molding, specialty lumber and parts.

特征：

- 每个容量高达 7500 磅
- 完全组装好，可立即使用
- 多层自由折叠，可自由伸缩
- 坚固轻便
- 易于操作，运输成本大大降低
- 低成本、最大的灵活性和最小的空间要求

Features:

- Capacity up to 7500 lbs each
- Completely assembled and ready for instant use
- Free-folding with multi-layer, retractable freely
- Sturdy and lightweight
- Easily handled with highly reduced transportation costs
- Low cost, maximum flexibility and minimum space requirements

COLLAPSIBLE WIRE MESH CONTAINER

可折叠置物笼

可折叠金属笼是更好的散装物料处理的理想选择，并更好的用于货物回收和节省空间的存储。

钢丝篮是坚固、可回收的容器系统，可提供高可见性节省、轻松处理、运输和存储散装零件和材料。这些坚韧的焊丝容器可快速识别内容物，促进更好的物料流动和更有效的库存控制。

篮筐自清洁，重量轻，坚固，重量比低，这意味着您可以移动更多的库存，更少的容器。内容物清晰可见，即使堆叠 3 或 4 个货架高。

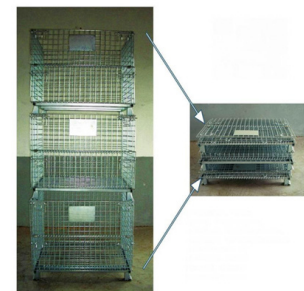

Collapsible Wire mesh containers are ideal for better bulk material handling and allow better return on shipments and space-saving storage.

Wire baskets are solid, returnable container systems that deliver high visibility savings, handle, transport and store bulk parts and material the easy way. These tough, welded wire containers provide quick content identification, promote better material flow, and more efficient stock control.

Baskets are self-cleaning, Light and strong with low weight-to-load ratio, which means you move more stock, less container. Contents are clearly visible, even when stacking 3 or 4 high.

STEEL PALLET

钢托盘



特征：

- 轻钢结构
- 镀锌，外形美观，经久耐用
- 容量 500 至 2000kg
- 使用寿命比其他类型的托盘长
- 尺寸和结构符合客户的要求
- 可以堆叠或装裱在地面上
- 应用广泛
- 提供 4 路和 2 路入口

Features:

- Light steel structure
- galvanized, sound appearance, durable
- Capacity 500 to 2000kg
- Long life-span than other types of trays
- Size & structure to customers' requirements
- Can be stacked or framed on the ground
- widely applications
- 4 way and 2 way entry be available

WIRE MESH PARTITION

金属隔离网

金属丝网隔断和面板是保护和划分大型仓库空间的绝佳方式。使用这些易于组装的金属丝网隔板和标准化金属丝网围栏保护您的贵重物品。

我们的金属丝网面板坚固耐用，采用金属丝网结构，是机器防护、工具室和隔离区域的理想选择。铁丝网配有单铰链门、挂锁凸耳和所有互连硬件。隔离层的安全区域允许光线穿透和空气流通，同时保持其内容物的安全。

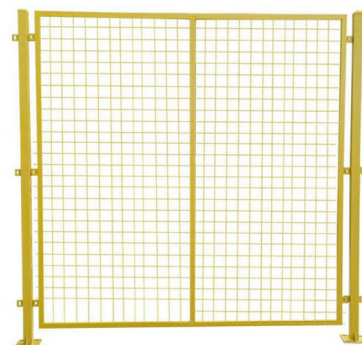

Wire Mesh Partition and Panels are excellent way to secure and divide large warehouse spaces. Protect your valuables with these easy to assemble wire mesh partitions and modular wire mesh enclosures.

Our wire mesh panels are sturdy with wire mesh construction that is ideal for machine guarding, tool rooms and isolation areas. Wire cages are equipped with single hinged doors, padlock lugs and all interconnecting hardware. This security room allows light penetration and air circulation while keeping its contents secure.

ABOUT US 關於我們



广州威裕物流应用技术有限公司按不同工商业需要及自身业务发展，活用最新科技，从而使客户在身处的行业领域中，成为耀眼的明灯。目前本公司服务包括项目管理与投资、物流供应链项目顾问、工业物流设备、专业建筑工程、室内设计装潢工程、建筑材料贸易等。

BPS Global (Guangzhou) Office utilizes the latest technology according to different commercial and industrial needs and its own business development so that customers can stand out from the crowd within the industry. The company's current services include project management and investment, logistics supply chain project consulting, industrial logistics equipment, professional construction engineering, interior design and fitting out, and building material trading and more.



广州威裕物流应用技术有限公司

BPS Global (Guangzhou) Office



+400 993 6993 (中国 China) | +852 2763 6874 (香港 Hong Kong)



https://www.bps-group.cn/website/gb/storage_rack.php



enquiry@bps-group.net